

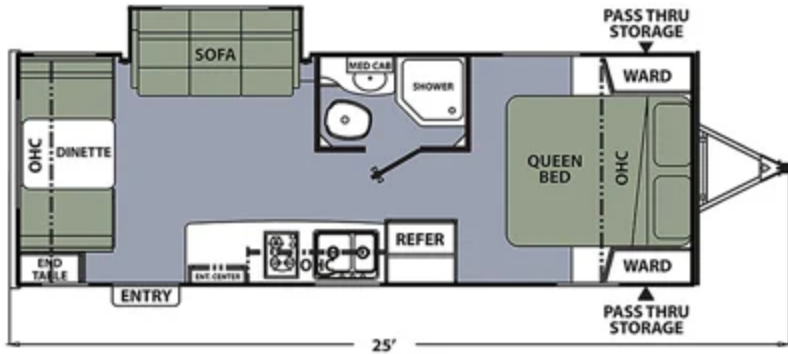

## 2020 APEX BY COACHMEN NANO SERIES M-213 RDS SPECS

# SPECIFICATIONS

## FLOOR PLAN



## IDENTIFICATION

Type  
**Travel Trailer**

Basic Warranty (Months)  
**12**

Revision Status  
**Carryover**

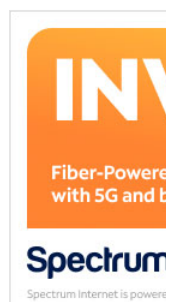

## SPECIFICATIONS

---

Maximum Sleeping Capacity  
**6**

Number Of Slideouts  
**1**

Length (ft-in / m)  
**25' 0" / 7.6**

Interior Height (in / mm)  
**81 / 2057.4**

Base Weight (lbs / kg)  
**3806 / 1726.4**

Carrying Capacity (lbs / kg)  
**2194 / 995.2**

Hitch Weight (lbs / kg)  
**467 / 211.8**

Number Of Axles  
**1**

Air Conditioning (BTUs)  
**13500**

Heater (BTUs)  
**20000**

---

## HOLDING TANKS

---

Fresh Water Capacity (gal / L)  
**50 / 189.3**

Gray Water Capacity (gal / L)  
**30 / 113.6**

Black Water Capacity (gal / L)  
**30 / 113.6**

Propane Capacity (gal / lbs)  
**4.7 / 20**

Water Heater Tank (gal / L)  
**N/A**

---



0:01 / 0:30

